



To build the world first-class brand



Guangzhou Baolun Electronic Technology Limited

Website: www.itctech.com.cn

E-mail: info@itc-pa.com.cn

Phone: +86 020 39378791

Address: Building NO. A13-1, Yiku Industrial Park, The Hills,
Dongyi Road, Panyu, Guangzhou, Guangdong Province, China 511492

Cloud-based HD Video Conference System V3.0

Deliver an instant connectivity and immersive
communication to your meeting rooms

System Diagram

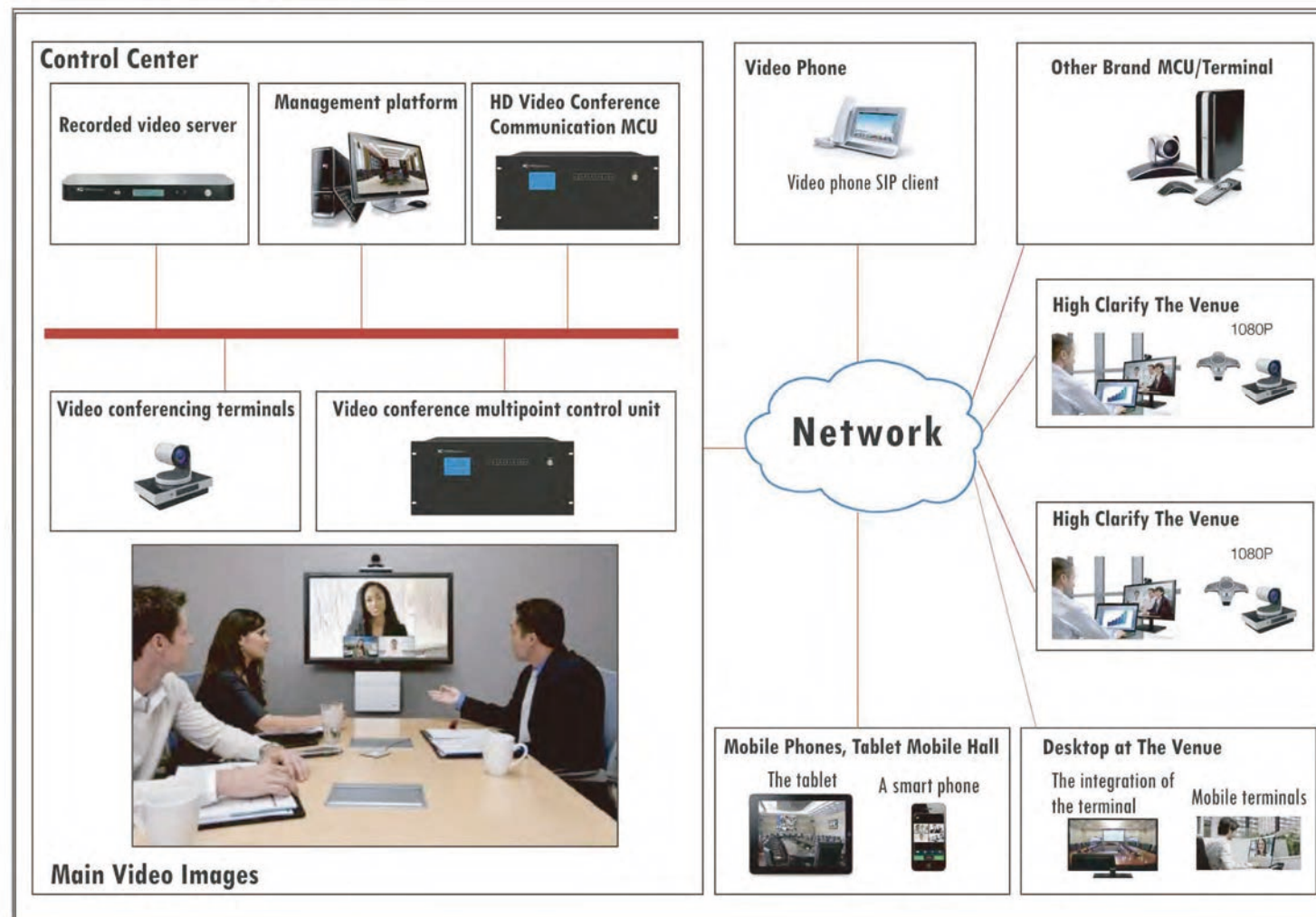

System Features

- ▶ **Six Service On One Box:** ITC VCS Server, integrated CMS、CRS、MCU、GK、live、record 6 functions , All services can be deployed individually and in combination according to actual needs. Graphical management tools allow unified management of equipment across the entire network, business monitoring, upgrade and maintenance, which significantly reduces OPEX.
- ▶ **Support MCU Resource Pool Mode:** The single machine supports 200 users to join, and MCU concatenation can reach 1000 users. Multiple MCU can be combined into a variety of cascading modes, including a tree cascade and a network cascade. The composition: "pool", in this MCU pool, resources can be shared and scheduled, and can be backed up.
- ▶ **TV Wall Output Function:** ITC cloud video conferencing VCS server, adopts the plug-in module design, supports 5 media resource cards, each board supports 4 HDMI interfaces. Supports up to 20 channels of HDMI interface, supports 20 channels of video conference screen, support output to large screen or video wall display, supports Ultra HD 4K resolution.
- ▶ **Multi-Screen Layout:** Supports multi-screen layout, the number of split screens is up to 64; automatic split screen is supported; in the same conference, all conference sites can transmit dual streams at the same time.
- ▶ **Extreme High Definition:** Using the industry's top video coder technology H.265 standard, ultra low bandwidth can achieve 4K extreme high-definition display. Only 2M is required to achieve 4K video effect; only 1M can achieve 1080P60 frame video effect; 512K can achieve 1080P30 frame video effect.

Cloud-based HD Video Conference Server Platform VCS8000 Series

- ▶ Module design with chassis and card plug-in.
- ▶ Built-in chart. It supports icon display to show the usage rate and meeting sites. The system can count information such as meeting times, meeting duration, number of meetings etc., according to time, meeting type and participants gathering.
- ▶ It supports distributed MCU composed of cloud architecture, in the whole system, as long as there is one MCU running, the meeting can run normally. Support multiple MCU to be tree cascading or reticular cascading modes to build a "MCU pool". In this pool, all resources can be shared, scheduled and backed up.
- ▶ One MCU max support 10 physical meeting, 100 concurrent virtual conferences, 200 channel 1080P concurrent users, allowing 1000 users to access into the meeting after cascaded.
- ▶ Support meetings of mixed speed, mixed video format, mixed protocol.



HD Video Conference Terminal of Medium and Large size conference room - NT90LT Series

- ▶ Adopting split type structure, built-in hardware video processing unit, with embedded operating system (not Windows or Android system) .
- ▶ With various interfaces, including 4-channel HD video inputs, 3 -channel HD video outputs.
- ▶ Supports 4K signal outputs and a single screen supports up to 25 video images
- ▶ With ultra strong network adaptability, it adjusts the resolution according to the network automatically to ensure the fluent meeting experience.



Small Size Integrated HD Video Conference Terminal NT90MT Series

- ▶ Adopting split type structure, built-in hardware video processing unit, with embedded operating system (not Windows or Android system) .
- ▶ With various interfaces, including one-channel HD video inputs, 2 -channel HD video outputs.
- ▶ With ultra strong network adaptability, it adjusts the resolution according to the network automatically to ensure the fluent meeting experience.
- ▶ With H.239 dual-stream protocol, both main and auxiliary streams can reach 1080P.

