

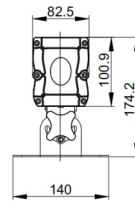

Water Effect Light

TL-LT103

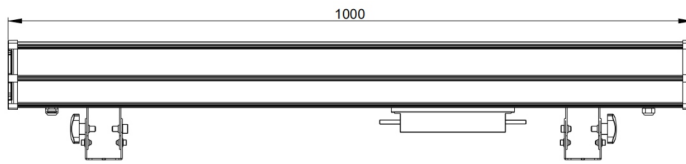

Feature:

- * Color: 3*40W (RGBW) red, green, blue and white LED.
- * Function: 1 water glass column, independent rotation, forward and backward stepless rotation, and adjustable speed.
- * Dimming: 0-100% linear adjustment.
- * Strobe: electronic strobe, 0-25 times/sec (built-in pulse stroboscopic effect).
- * DMX512 port program update, convenient and fast software update via DMX data cable.
- * Over-temperature protection function: built-in NTC temperature control function; when the LED is overheated, the output power will be intelligently reduced.
- * LCD blue screen display. The lamp usage time, software version number and others are displayed.

Specifications:

Model	TL-LT103
Input voltage	AC 110-240V 50/60Hz, 120W
Light source	3 OSRAM 40W (RGBW) red, green, blue and white LED
Average lifespan	50000H
Color temperature	7500K
Beam angle	22.5°
Control mode	Comply with the international standard DMX512 signal control protocol, 3-core (5-core optional) DMX512 signal interface; master-slave synchronous control mode, support RDM protocol and program online update function
Operation mode	DMX mode, user program mode, built-in program mode
Channel	5/9 channels
Fixture material	High-strength extruded aluminum + die-cast aluminum alloy end cover
Protection level	Protection IP67
Working temperature	-20°C~45 °C
Fixture size (L×W×H)	1000×140×174mm
Package size (L×W×H)	1075×250×255mm
Gross weight	9.4kg
Net weight	5.5kg